

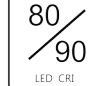

# LS-L4-NC

## NEW CONSTRUCTION ADJUSTABLE SQUARE LED RECESSED DOWNLIGHT

 DIMMING	 80 / 90 LED CRI	 15, 20, 30 Input Power	 1000 Lm 1500 Lm 2250 Lm Lumen Output	 2700K 3000K 3500K CCT
---	--	---	---	--

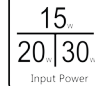
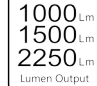

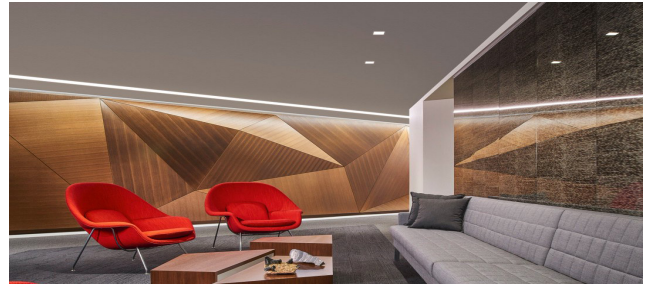
※ Square and Round Items share one mounting plate of round aperture.



### DESCRIPTION

4-way hanger bar install, the hanger bar can be adjusted from 14 1/2"-24", to adapt to a variety of joist structures and keel sizes.

Lamp height can be adjusted, accommodate 1/2" to 1 1/4" ceiling thickness. Trimmed and trimless available.

Rotated separated reflector, more convenient for parts replacement.

Isolation driver, high power factor and conversion efficiency, constant current output. Square new construction bottom plate can adjust 45°, suitable for special occasions. 4" and 6", square and round new construction share the same bottom plate. Different opening accessories, for fast replacement.

### TRIM

Die-casting aluminum, high-reflective powder spraying, high light uniformity.

### LIGHT SOURCE

High light transmittance, strong light diffusion performance, no shadow, no glare.

Point light source emitting turned into spherical light emitting.

Milky white light transmission rate reach 90% above.

Excellent concealed light source, achieve the best light transmission rate without seeing the LED lamp bead.

### RADIATOR

Excellent cold forging radiator, good heat dissipation.

### LISTING / WARRANTY

ETL listed to US and Canadian standards for damp location W/Feed through.

5 Years Limited Warranty.



### DIMENSIONS

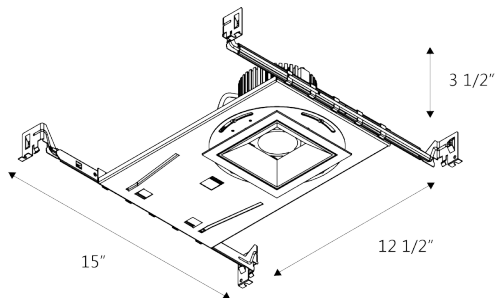

### TRIM OPTION

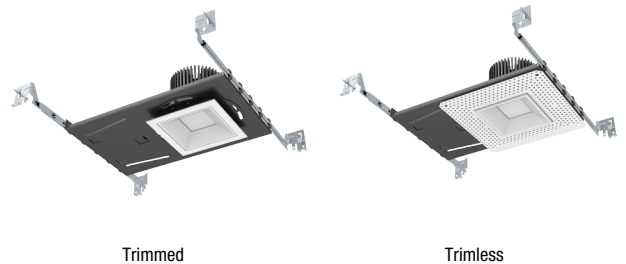

### ORDERING GUIDE / YOUR PRODUCT CODE

SERIES	TRIM	INPUT VOLTAGE	POWER/LUMEN	CCT	DIMMABLE	FINISH
○ LS-L4-NC 4" Adjustable LED Downlight	○ Trimmed ○ Trimless	○ 120V ○ 277V ○ 120-277V	○ 15W / 1000LM ○ 20W / 1500LM ○ 30W / 2250LM	○ 2700K ○ 3000K ○ 3500K	○ NONE ○ TRIAC ○ RD 0-10V	○ White ○ Black ○ Satin Nickel ○ Clear

\* Customized Also Available